

2537

KERN 20  
PART SERVER 30

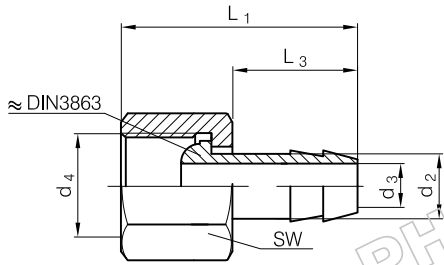

Mat.: Ms



2537 -  $d_2 \times d_4$

$d_3$	$L_1$	$L_3$	SW	$d_2$	$d_4$
6	34,5	19	17	9	G1/4

2540 5.8

DIN 906

KERN 20  
PART SERVER 30

2541 Ms

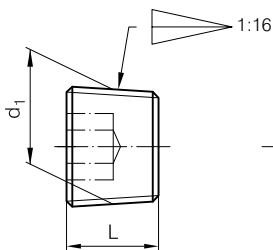

DIN 906 Mat.: 5.8, Ms



2540/2541 -  $d_1$

L	SW	$d_1$
8	4	M8x1
	5	M10x1 G1/8
10	6	M12x1,5 G1/4
	7	M14x1,5
	8	G3/8
	10	G1/2